

BT Quantum Programmable Key Module (PKM)

Installation with the 5330 IP Phone and 8528/8568 Digital Phones

To install the IP Programmable Key Module (PKM) Interface Module (IM), refer to the installation instructions on page 2.

To install the IP Programmable Key Module (PKM) 12, refer to the installation instructions on page 3.

To install the IP Programmable Key Module (PKM) 48, refer to the installation instructions on page 4.

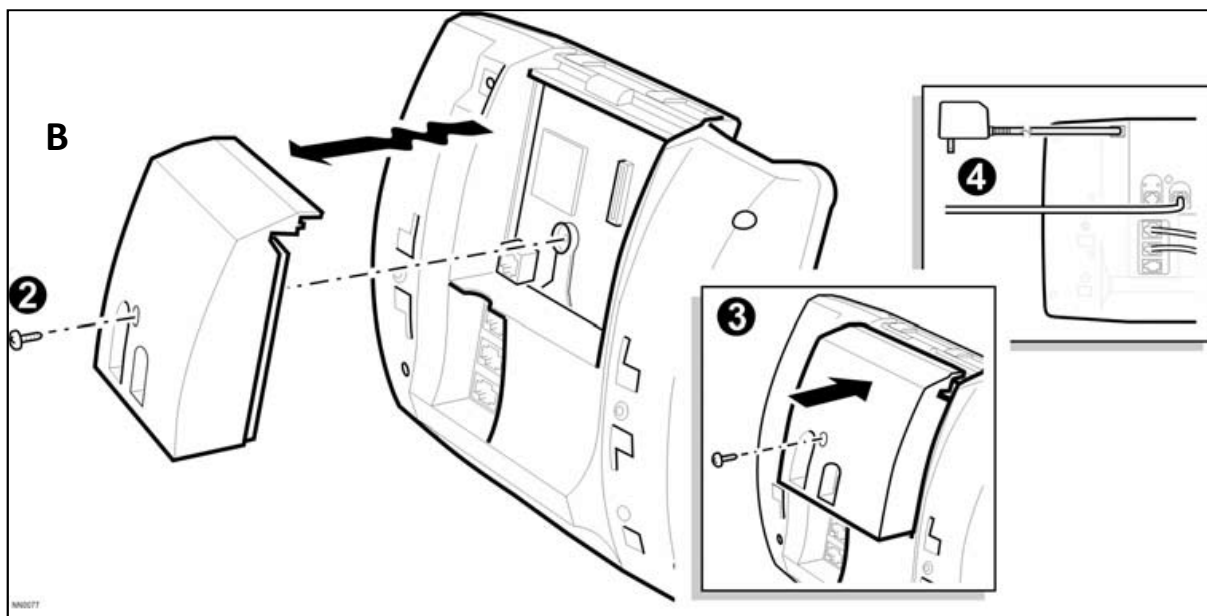
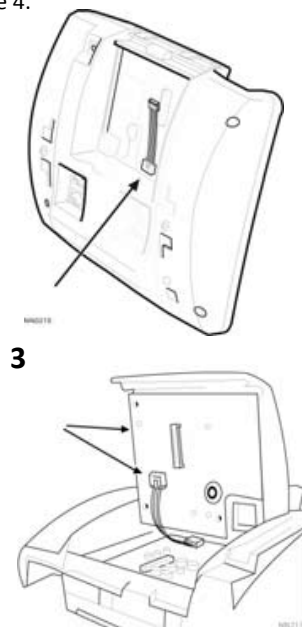
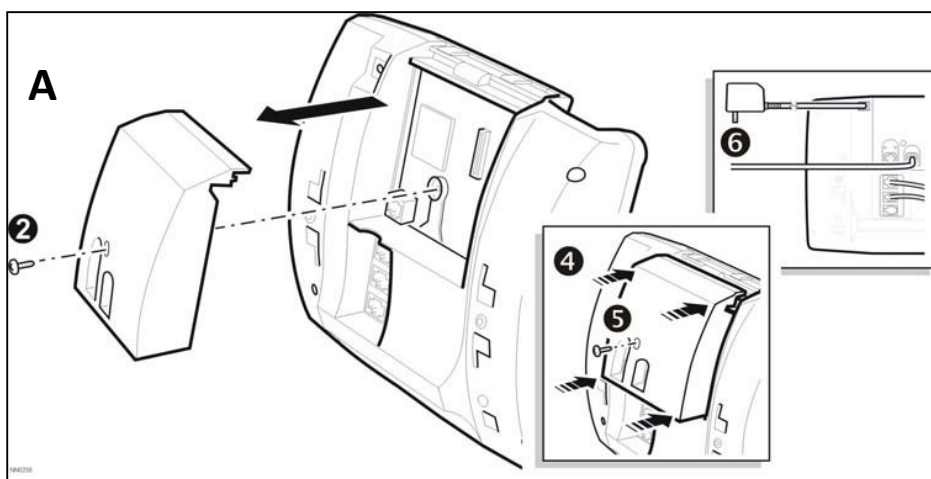

Important Safety Instructions and Precautions

WARNING: DO NOT CONNECT DIRECTLY TO THE PUBLIC SWITCHED TELEPHONE NETWORK (PSTN). ANY CONNECTION OF THIS UNIT TO AN OFF-PREMISE APPLICATION, AN OUT-OF-PLANT APPLICATION, ANY OTHER EXPOSED PLANT APPLICATION, OR TO ANY EQUIPMENT OTHER

THAN THE INTENDED APPLICATION MAY RESULT IN A SAFETY HAZARD, AND/OR DEFECTIVE OPERATION, AND/OR EQUIPMENT DAMAGE. AN "EXPOSED PLANT" IS WHERE ANY PORTION OF THE CIRCUIT IS SUBJECT TO ACCIDENTAL CONTACT WITH ELECTRIC LIGHTING OR POWER CONDUCTORS OPERATING AT A VOLTAGE EXCEEDING 300V BETWEEN CONDUCTORS OR IS SUBJECT TO LIGHTNING STRIKES. **Maintenance and Repair:** There are no user serviceable parts inside these units.

CAUTION: Installation of Modules shall only be performed by BT-qualified personnel.

These notices may appear on the product or in the technical documentation.

DANGER	Danger indicates an imminently hazardous situation which, if not avoided, will result in death or serious injury.
WARNING	Warning indicates a potentially hazardous situation which, if not avoided, could result in death or serious injury.
CAUTION	Caution indicates a potentially hazardous situation which, if not avoided, may result in minor or moderate injury and/or damage to the equipment or property.

This symbol may appear on the product.

	The exclamation point within an equilateral triangle indicates that important operating and maintenance (servicing) instructions are included in the literature accompanying the product
---	--

Description

The IP Programmable Key Modules (PKM) are peripheral devices providing connectivity (the Interface Module) or additional personal keys (the IP PKM12 and IP PKM48) for IP and Digital Phones.

The IP Programmable Key Module (PKM) Interface Module (IM) provides connectivity between the 5330 IP Phone or 8528/8568 Digital Phones and the IP PKM 12 / IP PKM 48.

NOTE: The IP PKM IM, IP PKM12, and IP PKM48 cannot be installed on a phone that has a Line Interface Module, 5310 Conference Unit, or Cordless Module installed.

Powering Requirements

The IP PKM Interface Module (IM) supplies the power to the IP PKM12 and IP PKM48. There are different powering requirements depending on which phone the IP PKM and IP PKM IM is attached to, as follows:

The DC adapter (24 v, PN(TBD)) is always required to power the IP PKM IM when used on a 8528/8568 Digital Phone.

The DC adapter (48 v) is not required when using a PKM 12/48 PKM48s on a 5330 IP Phone that is powered by PoE.

IP PKM IM Installation Instructions

To install an IP PKM IM (see Figure A on previous page)

CAUTION: Handle the IP PKM IM by the cover. Do not touch components or circuitry.

1. Unplug the phone from the system.

2. With a Phillips screwdriver, remove the screw from the module cover from the under side of the phone. Store the cover and screw.

NOTE: If you are using the IP PKM IM with a 5330 IP Phone, punch out the PC port tab of the IP PKM IM before installation.

3. For a 5330 IP Phone only:
 - Plug the jumper cable (included with the IP PKM IM) into the 4-pin cable connector on the main board of the 5330IP Phone.
 - Align the IP PKM IM against the phone and attach the other end of the jumper cable to the IP PKM IM connector.
4. Place the IP PKM IM and apply equal pressure to all sides of the cover until the IP PKM IM clicks into place.
5. Fasten the IP PKM IM cover with the supplied screw.
6. Reconnect the phone to the system and plug the power adapter or PoE LAN cable into the phone.

To remove an IP PKM IM (see Figure B on previous page)

1. Unplug the phone from the system, power adapter, and all cables from the IP PKM IM jacks. Unplug the power adapter from its power source.
2. With a Phillips screwdriver, remove the screw from the IP PKM IM from the under side of the phone. Store the screw. Grasp the IP PKM IM and gently pull the IP PKM IM from the phone.
3. Replace the phone's original cover and fasten it with the screw removed in Step 2 of installing an IP PKM IM.
4. Reconnect the system and interface cables to the phone.

IP Programmable Key Module (PKM) 12

To install the IP Programmable Key Module (PKM) Interface Module (IM), refer to the installation instructions on page 2.

To install the IP Programmable Key Module (PKM) 48, refer to the installation instructions on page 4.

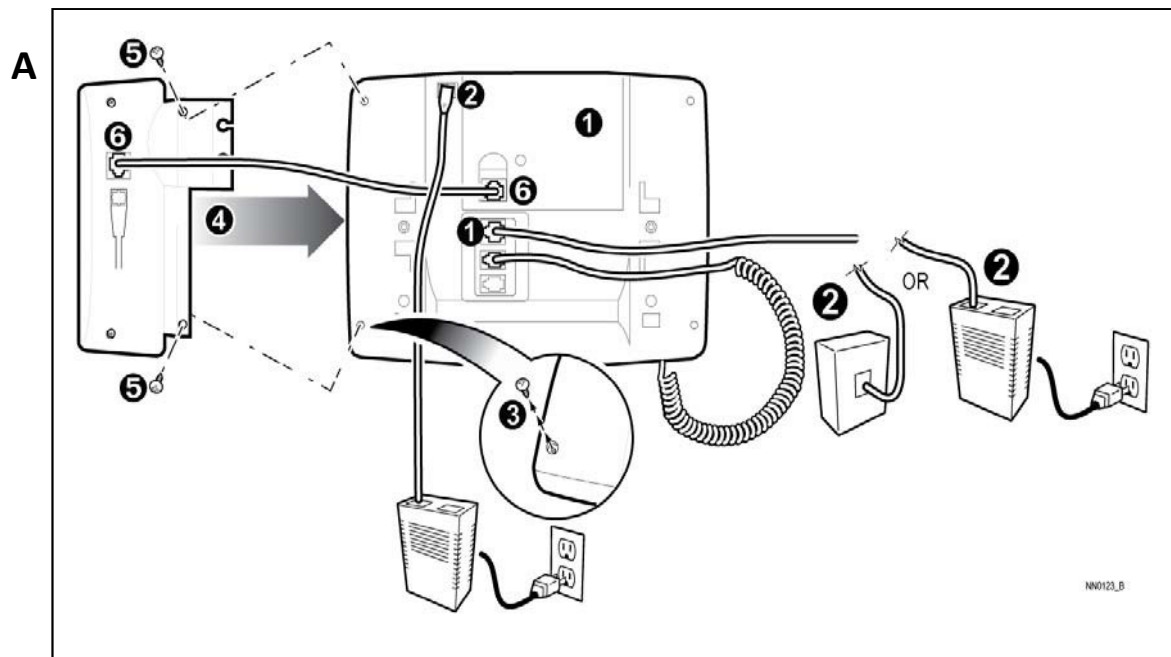

Installation Instructions

To attach an IP PKM 12 to a 5330 IP Phone or 8528/8568 Digital Phone (see Figure A)

1. Ensure that the system has been programmed to recognize the IP PKM12, that the phone is connected to the system, and that a BT engineer has installed an IP PKM IM in your 5330 IP Phone or 8528/8568 Digital Phone.
2. 8528/8568 Only: Ensure that the appropriate DC adapter is plugged into the power jack under the phone.
3. Remove the top and bottom screws on the back, left side of the phone.
4. Slide the IP PKM 12 onto the left side of the phone. Ensure that the top and bottom holes on the IP PKM 12 align with those on the back, left side of the phone.
5. Connect the IP PKM 12 to the phone using screws provided in the small envelope.
6. Plug the RJ45 cable into the IP PKM 12 and the IP PKM IM. The LEDs will temporarily flash and then go out. Continually flashing LEDs indicate incorrect installation or programming.
7. Program the keys as described in your 5330 IP Phone or 8528/8568 Digital Phone User Guide

NOTE: The IP PKM 12 will not function until it is identified in Customer Data Entry programming by your System Administrator.

IP Programmable Key Module (PKM) 48

To install the IP Programmable Key Module (PKM) Interface Module (IM), refer to the installation instructions on page 2.

To install the IP Programmable Key Module (PKM) 12, refer to the installation instructions on page 4.

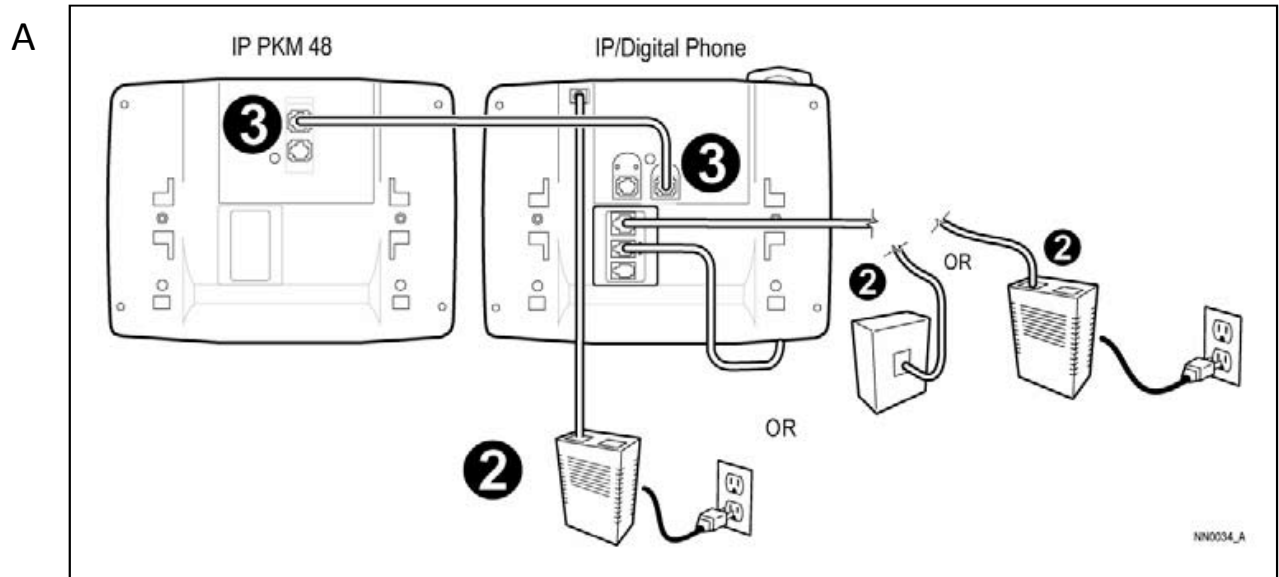

Installation Instructions

To attach an IP PKM 48 to a 5330 IP Phone or 8528/8568 Digital Phone (see Figure A above)

1. Ensure that the system is programmed to recognize the IP PKM 48, and that a Mitel-qualified technician has installed an IP PKM IM in your phone.
2. 8528/8568 Only: Ensure that the phone is connected to the system, and that the appropriate DC adapter is plugged into the power jack under the phone.
3. Plug the modular cable into the jack under the IP PKM 48 and the IP PKM IM on the phone. The LEDs will temporarily flash, and then go out. Continually flashing LEDs indicate incorrect installation or programming.
4. Route and bundle excess cable, and tuck it underneath the phone stand.
5. Program the keys as described in your 5330 IP Phone or 8528/8568 Digital Phone user guides. Your System Administrator may have to program some features.

NOTE: The IP PKM 48 will not function until it is identified in Customer Data Entry programming by your System Administrator



The telecommunications services described in this publication are subject to availability and may be modified from time to time. Services and equipment are provided subject to British Telecommunications plc's respective standard conditions of contract. Nothing in this publication forms any part of any contract.

© British Telecommunications plc 2011.

Registered Office: 81 Newgate Street, London EC1A 7AJ.

Registered in England No: 1800000.

Produced by BT Business Information Systems Marketing



The CE Marking on this equipment indicates Compliance with the following

This device conforms to Directive 1999/5/EC on Radio Equipment and Telecommunications Terminal Equipment as adopted by the European Parliament And Of The Council